

Citizens' Advisory Committee

Meeting 4

November 7, 2022

Our Mission: Empowering lifelong learners to be engaged citizens who positively impact their local and global community.



Welcome from your Superintendent

Dr. Jamie Wilson
Superintendent
Denton ISD



Agenda

- WELCOME
- PROCESS REVIEW
- LAND OVERVIEW
- PROJECT PRIORITIES
- CLOSING



TRANSCEND⁴

Collaboration | Communication | Critical Thinking | Creativity

Dr. Lizzy Johnson

Facilitator

lizzy@transcend4.com

940.595.0251

Charge to Committee

To help the district plan for the future, the Citizens' Advisory Committee is charged to:

- Assess and prioritize the district's current and long-term facility needs, including, but not limited to:
 - District growth and capacity
 - Building age, safety and condition
 - Land acquisition
 - Evolving educational delivery and programs
 - Energy efficiency and sustainable features
- Develop and prioritize potential projects, including new construction, renovations/additions, technology, and other areas that may arise from community input
- Consider the educational needs of all students and align recommendations with the district's mission, vision and goals
- Represent the entire school district community, values and perceptions, and seek input from other residents
- Consider the district's current financial position and funding methods to develop a recommendation that is fiscally sound
- Make a recommendation to the Board of Trustees that addresses the district's growth and facility needs based on the Committee's identified priorities



Housekeeping

- All relevant materials and information will be distributed to you as handouts.
- Due to time constraints, no breaks have been scheduled. Please take care of your personal needs on your own.
- The Denton ISD Leadership Team is here to serve you and to be a resource. Ask questions.
- Your attendance at every meeting will help yield optimum results for this committee and your community.



Ground Rules

- Only one speaker at a time
- Respect the person who is speaking
- Listen with a desire to contribute & learn
- Engage in the ENTIRE meeting



Q&A Process

- Each table will discuss the information presented and select one question to ask.
- Unanswered questions or concerns will be placed on the 'parking lot' to be answered later via email or website post.



Consensus & Gradients of Agreement Model

ENDORSEMENT "I like it."	ENDORSEMENT WITH A MINOR POINT OF CONTENTION "Basically, I like it."	AGREEMENT WITH RESERVATIONS "I can live with it."	ABSTAIN "I have no opinion."	STAND ASIDE "I don't like this, but I don't want to hold up the group."	FORMAL DISAGREEMENT, BUT WILLING TO GO WITH THE MAJORITY "I want my disagreement noted in writing, but I'll support the decision."	FORMAL DISAGREEMENT, WITH REQUEST TO BE ABSOLVED OF RESPONSIBILITY "I don't want to stop anyone else, but I don't want to be involved in implementing it."	BLOCK "I veto this proposal."
------------------------------------	--	---	--	---	--	--	---

This scale makes it easier for participants to be honest. Using it, members can register less-than-whole hearted support without fearing that their statement will be interpreted as a veto.



Dynamics of Group Decision-Making

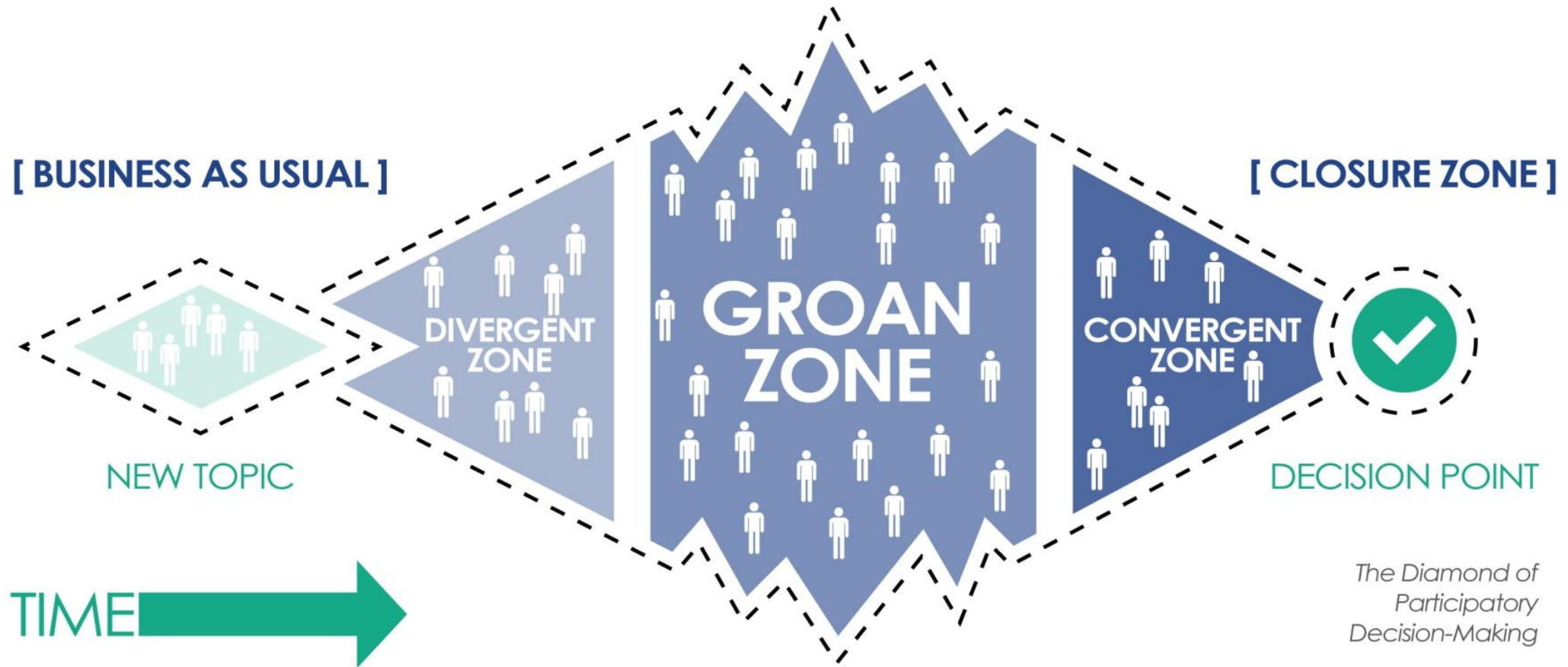

Consensus Building Model

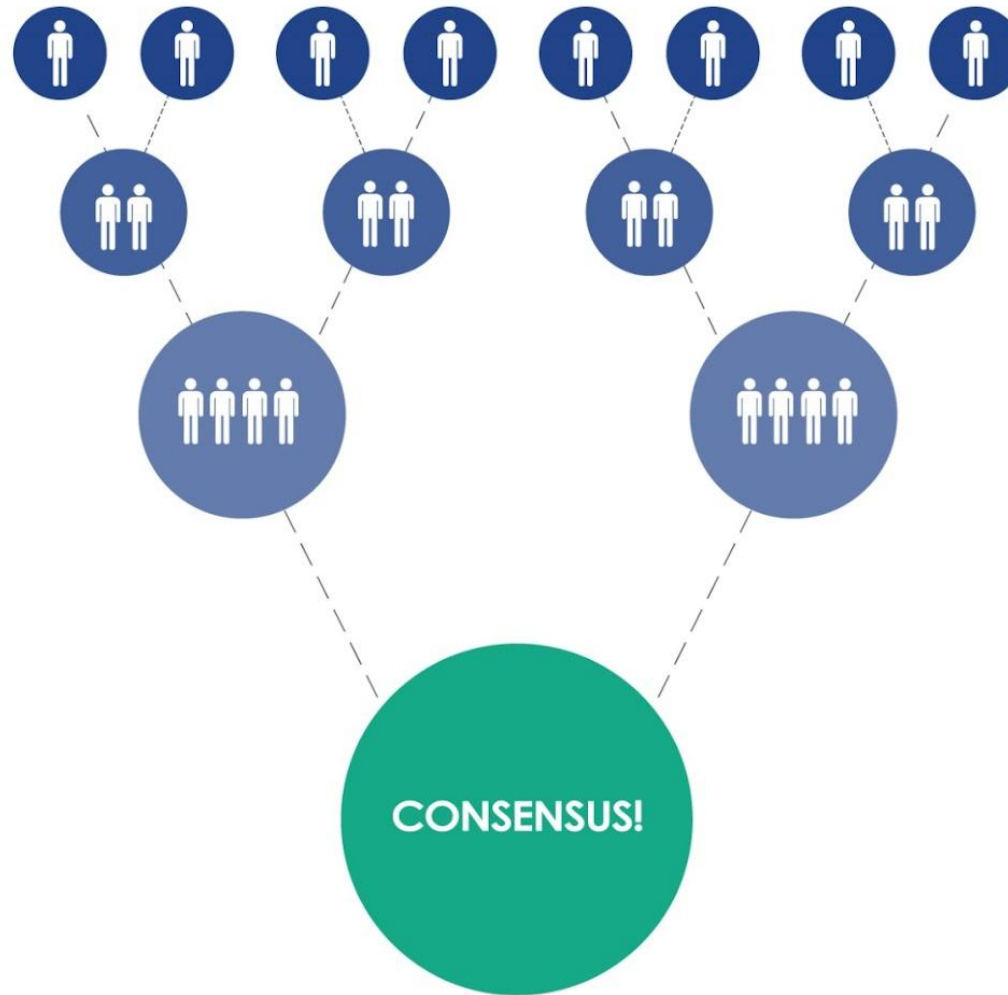

Meeting Overview

Meeting #1

Process, timeline, vision, end goal
Charge from Board of Trustees
School Finance 101
Overview of 2018 Bond Projects

Meeting #2

Demographic Report
Facility Needs Assessment
Safety & Security
Technology & Infrastructure

Meeting #3

Athletics
Child Nutrition & Transportation
CTE & Fine Arts
Video Facility Tours

Meeting #4

Land Overview
Project Priority Presentation
Priority Worksheet

Meeting #5

Financial Advisor Presentation
Priority Worksheet and Mock Vote

Meeting #6

Bond Package Development with CoVoice
SWOT Analysis regarding potential bond



CAC Information Link
<https://www.dentonisd.org/cac2022>

Construction/2018 Bond Projects Link
www.dentonisd.org/construction

Our Mission: Empowering lifelong learners to be engaged citizens who positively impact their local and global community.





DENTON ISD

LRFP Committee Meeting No. 4

November 7, 2022

Our Mission : Empowering lifelong learners to be engaged citizens who positively impact their local and global community.





AGENDA

Long-Range Facilities Plan

Enrollment Growth

Career Technology Education

Athletics

Fine Arts

Capital Improvements

Support Facilities

District Needs



LONG-RANGE FACILITIES PLAN - OPINION OF PROBABLE COST



- Solutions are formalized
- Opinions of probable project costs
 - Right-sized square footage and programming
 - Appropriate unit costs
 - Contingency
 - On-site and off-site costs & soft costs
 - Furnishing fixtures
 - Equipment costs
 - Inflation



LONG-RANGE FACILITIES PLAN - OPINION OF PROBABLE COST

- PROGRAM CONTINGENCY = allows for program development
- ON-SITE CONTINGENCY = allows for detention, foundation, topography
- OFF-SITE CONTINGENCY = allows for road construction, utility extension
- FEES = based on percentage of construction cost
All fees and permits required to produce documents, design, reports and testing to satisfy jurisdictional approval
- FFE = based on percentage of construction cost (averages 5-10 %)
- T.E. Equipment = Cost to supply technology infrastructure and equipment
- INFLATION**
Prediction based on contractor input, the AGC, historical avgs

OPINION OF PROBABLE COST			
Description			
Construction Cost			
Renovations - Minor (paint, flooring)	80,000 SF	\$ 11	\$ 848,000
Renovations - Major	30,000 SF	\$ 106	\$ 3,180,000
Program Contingency		1.0%	\$ 8,480
On-Site Contingency		2.0%	\$ 16,960
Off-Site Construction Cost		0%	\$ -
Subtotal			\$ 4,053,440
Contingency/Allowance			
Owner's Betterment		2.0%	\$ 81,069
Contractor's Contingency		2.0%	\$ 81,069
Subtotal			\$ 162,138
Jurisdictional & Professional Fees			
(Includes costs, fees, tests and studies required to satisfy all governing authorities and codes)			
Site Survey, Subsurface Utility Engineering, Due Dilligence / Property Evaluation, Geotechnical Engineering, Architectural Engineering, TDLR / TAS / ADA Review and Inspection, Food Service Design, On-Site Civil Engineering, Material Testing, HVAC Test and Balance, Building Permit / Review and Inspections			
Subtotal		11%	\$ 463,714
Fixtures, Furniture & Equipment (FF&E)			
		6%	\$ 252,935
T.E. Equipment			
		EA	\$ 189,701
	MARCH 2019	\$	5,121,927
		\$	978,370
PROJECT COST	MARCH 2022	\$	6,100,297
Land Acquisition		\$	-
TOTAL PROJECT COST		\$	6,100,297

- SQUARE FOOTAGE = program driven
- UNIT COSTS = defined by local market, similar building comparisons
- OWNER'S BETTERMENT = to cover post-bid changes
- CONTRACTOR CONTINGENCY = allows acceleration, scope gap
- TOTAL PROJECT COST (IN TODAY'S DOLLARS)**
\$5,121,927
- TOTAL PROJECT COST**
\$6,100,297





ENROLLMENT GROWTH



LONG-RANGE FACILITIES PLAN - ELEMENTARY CAPACITY



Ten Year Forecast by Elementary Campus

By the Fall of 2023, seven schools will exceed their capacity

By the Fall of 2025, an additional four schools will also exceed their capacity

Campus Name	Capacity	HISTORY		ENROLLMENT PROJECTIONS									
		2020/21	Fall 2021/22	2022/23	2023/24	2024/25	2025/26	2026/27	2027/28	2028/29	2029/30	2030/31	2030/32
Alexander Elementary School	740	580	600	592	600	613	621	636	650	654	669	681	692
Adkins Elementary School	740	435	444	454	474	495	487	513	513	517	520	514	511
Bell Elementary School	740	653	714	718	715	717	713	716	718	724	724	733	738
Blanton Elementary School	740	479	492	504	508	512	514	520	517	515	515	524	534
Borman Elementary School	740	434	432	430	473	587	742	879	1,013	1,151	1,284	1,401	1,518
Cross Oaks Elementary School	740	668	720	728	730	756	772	786	799	803	802	813	813
E P Rayzor Elementary School	740	311	310	313	306	305	310	319	322	333	341	350	359
Evers Park Elementary School	740	543	621	680	771	827	925	996	1,004	1,023	1,049	1,087	1,117
Ginnings Elementary School	740	583	665	717	752	778	812	822	818	803	792	783	774
Hodge Elementary School	740	618	658	680	737	828	905	1,014	1,057	1,087	1,126	1,172	1,195
Sam Houston Elementary School	740	530	532	534	537	540	568	563	568	573	585	594	609
Nelson Elementary School	740	577	569	553	579	576	595	594	607	616	608	611	615
McNair Elementary School	740	534	533	515	511	542	550	562	565	573	576	592	609
Hawk Elementary School	740	568	595	582	598	589	571	613	622	632	634	649	660
Olive Stephens Elementary School	740	379	421	487	556	626	701	771	777	782	786	801	813
Paloma Creek Elementary School	740	648	685	718	742	785	843	858	885	904	915	936	953
Pecan Creek Elementary School	740	643	663	658	664	657	666	673	668	662	663	653	651
Providence Elementary School	740	554	656	760	889	1,025	1,134	1,242	1,289	1,339	1,393	1,454	1,514
Newton Rayzor Elementary School	740	614	632	640	644	641	653	663	670	677	682	686	683
Rivera Elementary School	740	540	625	673	691	706	756	777	754	743	743	738	728
Sandbrock Ranch Elementary School	740	0	0	631	789	855	944	995	1,052	1,102	1,166	1,212	1,256
Savannah Elementary School	740	641	778	807	843	868	860	879	879	871	871	856	847
Ryan Elementary School	740	544	560	561	587	585	578	570	603	637	670	709	734
Union Park Elementary School	740	727	962	649	801	849	885	900	961	1,027	1,092	1,131	1,168
Schultz Elementary School	740	567	642	669	684	703	725	744	737	739	746	737	740
Ann Windle School For Young Child	740	252	307	344	358	374	388	404	420	431	436	447	457
Gonzalez School For Young Child	740	248	270	333	347	363	377	393	409	420	425	436	446
ELEMENTARY TOTALS	19,980	13,870	15,086	15,929	16,885	17,699	18,595	19,402	19,875	20,333	20,810	21,304	21,733
Elementary Absolute Change		-631	1,216	843	956	815	895	807	473	458	477	493	429
Elementary Percent Change		-4.35%	8.77%	5.59%	6.00%	4.82%	5.06%	4.34%	2.44%	2.30%	2.35%	2.37%	2.01%

Yellow box = over capacity



LONG-RANGE FACILITIES PLAN - ELEMENTARY GROWTH

\$341,501,698

Construct new elementary schools at:

- Riney Road (Projected to open 2024)
- Spiritas Rd East (Projected to open 2024)
- Spiritas Rd West (Projected to open 2024)
- Cheek Site (Projected to open 2025)
- Country Lakes (Projected to open 2026)
- Capacity 750 students



LONG-RANGE FACILITIES PLAN - ELEMENTARY GROWTH

\$79,601,594

Construct new elementary school at:

- Hunter Ranch (Projected to open 2027)
- Capacity 750 Students



LONG-RANGE FACILITIES PLAN - SECONDARY SCHOOLS CAPACITY



Ten Year Forecast by Secondary Campus

By the Fall of 2024, enrollment at both Braswell High School and Ryan High School is expected to exceed the school capacity

Campus Name	HISTORY		ENROLLMENT PROJECTIONS										
	Capacity	2020/21	Fall 2021/22	2022/23	2023/24	2024/25	2025/26	2026/27	2027/28	2028/29	2029/30	2030/31	2030/32
Calhoun Middle School	1,268	664	700	712	701	768	772	818	859	958	1,016	1,043	1,078
McMath Middle School	1,181	804	812	795	790	812	810	880	924	1,036	1,094	1,171	1,232
Navo Middle School	1,181	1,025	1,063	1,124	1,191	1,301	1,363	1,478	1,514	1,544	1,553	1,573	1,592
Crownover Middle School	1,181	874	813	820	732	771	755	777	745	739	782	793	804
Strickland Middle School	1,334	901	975	992	1,012	1,025	1,051	1,101	1,191	1,269	1,336	1,361	1,388
Harpool Middle School	1,181	875	867	818	798	769	795	781	820	813	853	844	851
Rodriguez Middle School	1,323	961	988	1,070	1,186	1,352	1,500	1,661	1,796	1,904	1,990	2,049	2,083
Bette Myers Middle School	1,323	880	834	822	822	883	924	946	1,006	1,091	1,149	1,133	1,135
MIDDLE SCHOOL TOTALS	9,972	6,984	7,052	7,153	7,232	7,681	7,970	8,442	8,855	9,354	9,773	9,967	10,163
Middle School Absolute Change		-139	68	101	79	449	289	472	413	499	419	194	196
Middle School Percent Change		-1.95%	0.97%	1.43%	1.10%	6.21%	3.76%	5.92%	4.89%	5.64%	4.48%	1.99%	1.97%
Braswell High School	3,350	2,446	2,728	3,020	3,173	3,351	3,523	3,701	4,029	4,433	4,736	5,043	5,300
Denton High School	2,460	2,023	1,924	1,996	2,046	2,069	2,113	2,116	2,176	2,180	2,295	2,458	2,600
Fred Moore High School		68	56	56	56	56	56	56	56	56	56	56	56
John Guyer High School	3,200	2,621	2,626	2,597	2,617	2,521	2,478	2,376	2,317	2,345	2,292	2,382	2,397
Ryan High School	2,340	2,197	2,226	2,286	2,364	2,370	2,360	2,380	2,443	2,491	2,580	2,782	2,926
The LaGrone Academy		0	202	237	237	0	0	0	0	0	0	0	0
HIGH SCHOOL TOTALS	11,350	9,355	9,762	10,192	10,493	10,367	10,530	10,629	11,021	11,505	11,959	12,721	13,279
High School Absolute Change		185	407	430	301	-126	163	99	392	484	454	762	558
High School Percent Change		2.02%	4.35%	4.41%	2.95%	-1.20%	1.57%	0.94%	3.69%	4.39%	3.95%	6.37%	4.39%
Denton J J A E P		8	4	4	4	4	4	4	4	4	4	4	4
Juvenile Detention CTR		43	50	50	50	50	50	50	50	50	50	50	50
Lester Davis School		7	52	52	52	52	52	52	52	52	52	52	52
ALTERNATIVE SCHOOL TOTALS		58	106	106	106	106	106	106	106	106	106	106	106
DISTRICT TOTALS	41,302	30,267	32,006	33,380	34,716	35,853	37,201	38,579	39,857	41,298	42,648	44,098	45,281
District Absolute Change		-641	1,739	1,374	1,336	1,137	1,347	1,378	1,278	1,441	1,350	1,449	1,183
District Percent Change		-2.1%	5.7%	4.3%	4.0%	3.3%	3.8%	3.7%	3.3%	3.6%	3.3%	3.4%	2.7%

Yellow box = over capacity



LONG-RANGE FACILITIES PLAN - SECONDARY SCHOOLS GROWTH

\$157,332,011

Construct new Middle School

- Capacity 1,000
- 180,000 sf
- Projected to Open Fall of 2031



LONG-RANGE FACILITIES PLAN - SECONDARY SCHOOLS GROWTH

\$336,226,858

Construct High School No. 5

- Capacity 2,500
- 515,000 sf





CAREER TECHNOLOGY EDUCATION



LONG-RANGE FACILITIES PLAN - CAREER TECHNOLOGY EDUCATION

\$93,078,735

Career Technology Academy - On Site of High School #5

- Approximately 140,000 SF
- Scheduled to open 2026



LONG-RANGE FACILITIES PLAN - CAREER TECHNOLOGY EDUCATION

\$21,348,692

LaGrone ATC Additions

- Added classroom spaces and science labs with interior renovations
- Added Large Group Instruction Areas
- Scheduled to complete 2025



LONG-RANGE FACILITIES PLAN - CAREER TECHNOLOGY EDUCATION

\$10,306,366

New Agricultural Barn

- Construct new agricultural barn for sheep, goats, and chickens serving the east side of the district



LONG-RANGE FACILITIES PLAN - CAREER TECHNOLOGY EDUCATION

\$3,035,235

Guyer High Agricultural Barn Improvements

- Add new barn (8,000 SF)
- Improve security
- Provide fenced pasture area
- Improve drainage around existing barn
- Scheduled to complete 2025





ATHLETICS



LONG-RANGE FACILITIES PLAN - ATHLETICS

\$30,957,886

Middle School Track and Field Replacements at:

- Crownover MS
- Harpool MS
- McMath MS
- Navo MS
- Strickland MS
- Myers MS
- Rodriguez MS
- Replace sod fields with artificial turf
- Replace existing running tracks
- Resurface existing tennis courts
- Construct Track/Field Storage building



LONG-RANGE FACILITIES PLAN - ATHLETICS

\$8,953,662

High School Equity

- Add artificial turf to baseball and softball fields at Braswell High
- Add artificial turf to softball field at Ryan High
- Reconfigure baseball and softball batting cages/bullpens/storage at Braswell High

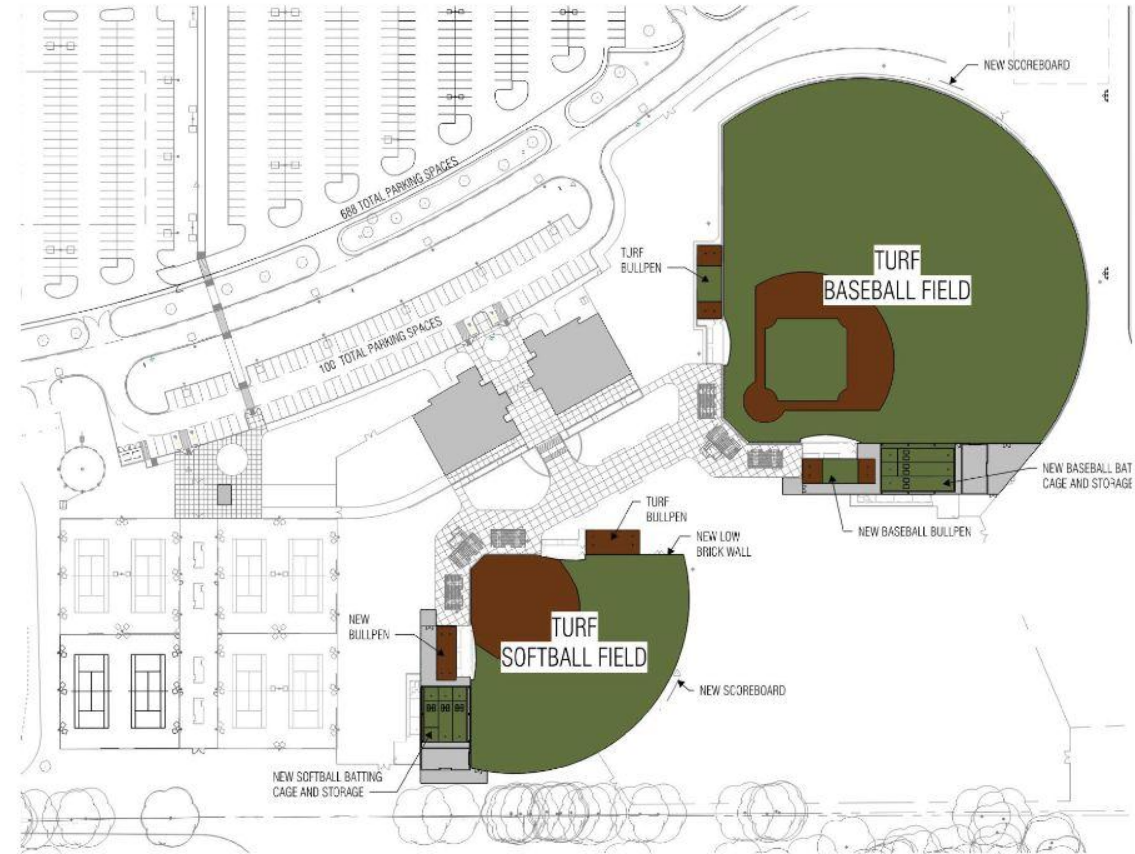

LONG-RANGE FACILITIES PLAN - ATHLETICS

\$108,379,232

Multi-Purpose Facilities at

- Denton HS
- Ryan HS
- Guyer HS
- Braswell HS
- High School No.5
- HS No. 5
- Approximately 100,000 sf consisting of full synthetic field, storage space, and restrooms

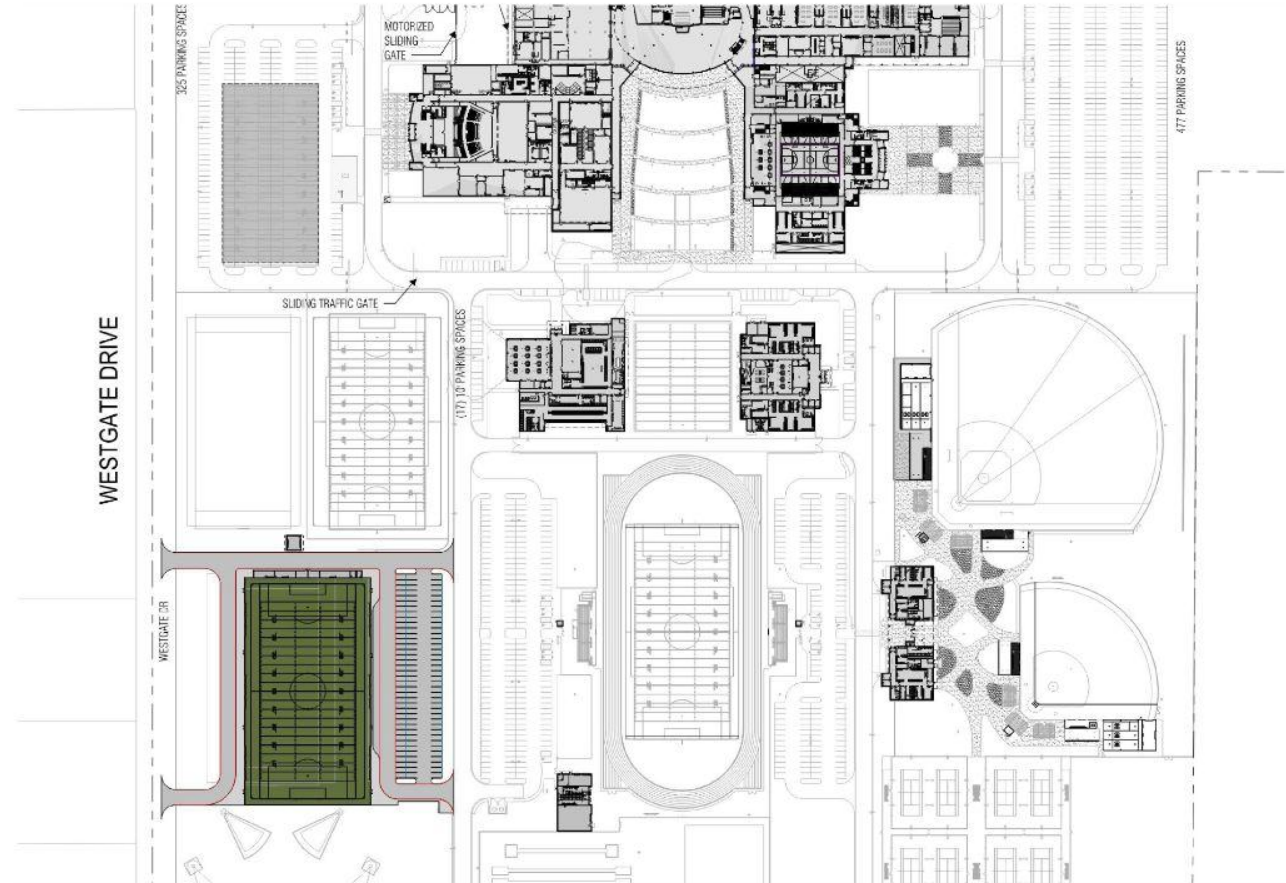

LONG-RANGE FACILITIES PLAN - ATHLETICS

\$5,273,453

C.H. Collins Renovations

- Construct officials dressing/storage building at south end of field
- Interior renovations to press box
- Elevator replacement
- Parking lot lighting replacement with LED



LONG-RANGE FACILITIES PLAN - ATHLETICS

\$3,605,127

Bronco Field Renovations

- Replace field lighting
- Renovations to restrooms/ concessions
- General renovations to press box and bleachers
- Provide new scoreboard



LONG-RANGE FACILITIES PLAN - ATHLETICS

\$41,060,078

Practice Natatorium

- 50 meter practice venue
- Projected to complete 2025



LONG-RANGE FACILITIES PLAN - ATHLETICS

\$2,476,591

Guyer High School Baseball

- New concession/restroom building (approximately 1,900 SF)
- Provide additional parking
- Provide secure bus parking area
- Reconfigure fencing separating from Ag Barn area

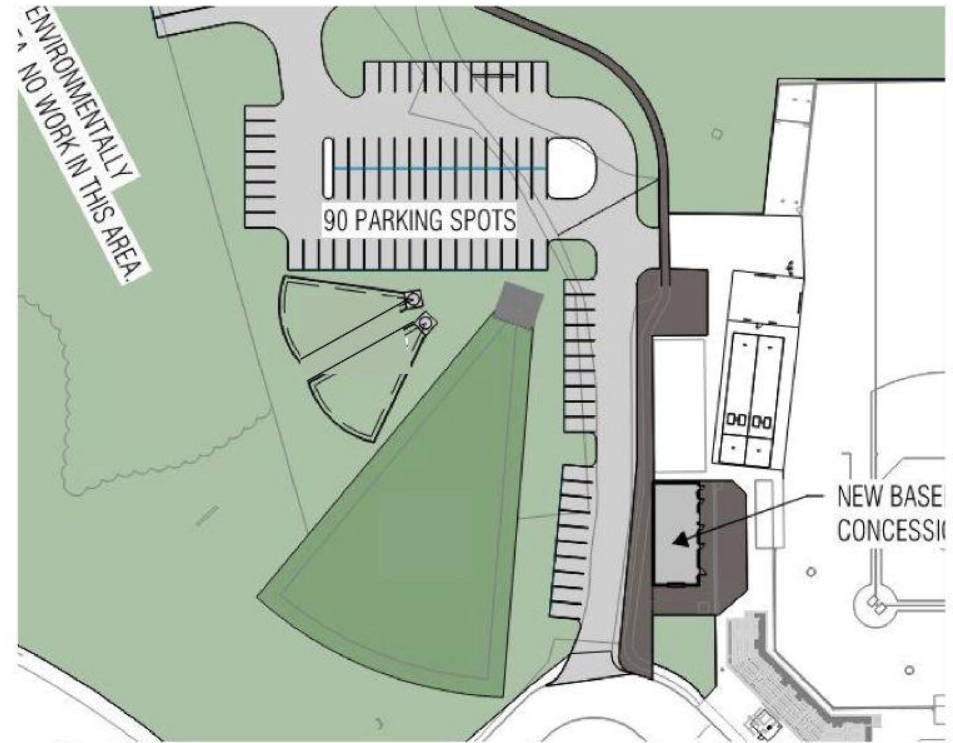



FINE ARTS



LONG-RANGE FACILITIES PLAN - FINE ARTS

\$4,901,528

Elementary School Fine Arts Replacements

- Replace stage curtains
- Replace stage lighting with LED lighting and controls
- Replace Cafetorium/Stage sound system
- Schools affected;
 - Alexander ES
 - Blanton ES
 - Cross Oaks ES
 - EP Rayzor
 - Evers ES
 - Hawk ES
 - Hodge ES
 - Houston ES
 - McNair ES
 - Nelson ES
 - Paloma Creek ES
 - Providence ES
 - Pecan Creek ES
 - Rivera ES
 - Savannah ES
 - Stephens ES
 - WS Ryan ES





Table Talk Q&A Process

Our Mission: Empowering lifelong learners to be engaged citizens who positively impact their local and global community.





EXISTING CAMPUS REPLACEMENTS



LONG-RANGE FACILITIES PLAN - CAMPUS REPLACEMENT

\$68,932,499

Replacement Borman Elementary

- Approximately 110,000 SF
- Capacity 750 students
- Scheduled to open 2025



LONG-RANGE FACILITIES PLAN - CAMPUS REPLACEMENT

\$69,002,911

Replacement Ginnings Elementary

- Approximately 110,000 SF
- Capacity 750 students
- Scheduled to open 2025





CAPITAL IMPROVEMENTS: ELEMENTARY



LONG-RANGE FACILITIES PLAN - CAPITAL IMPROVEMENT - ELEMENTARY

\$109,324,517

ELEMENTARY PACKAGE ONE

Campus renovation to include:

- Replace wall and floor finishes
- Replace ceilings
- Replace lighting with LED
- Replace doors and hardware
- Replace casework
- Renovate restrooms
- Update technology, fire alarm, communications.

Campuses included are those over 20 years old: Anne Windle ECC, E.P.Rayzor ES, Evers ES, Hodge ES, Houston ES, McNair ES, Rayzor ES, Pecan Creek ES, Rivera ES, W.S.Ryan ES



LONG-RANGE FACILITIES PLAN - CAPITAL IMPROVEMENT - ELEMENTARY

\$95,148,931

ELEMENTARY PACKAGE TWO

Campus renovation to include:

- Replace wall and floor finishes
- Replace ceilings
- Replace lighting with LED
- Replace doors and hardware
- Replace casework
- Renovate restrooms
- Update technology, fire alarm, communications.

Campuses included are those that are less than 20 years old: Alexander ES, Blanton ES, Hawk ES, Nelson ES, Paloma Creek ES, Providence ES, Savannah ES, Stephens ES





CAPITAL IMPROVEMENTS: SECONDARY



LONG-RANGE FACILITIES PLAN - CAPITAL IMPROVEMENT - SECONDARY

\$3,522,446

Secondary Schools - Capital Improvements

- Replace floor finishes at Navo M.S.
- Replace floor finishes at Harpool M.S.
- Extend stage area at cafeteria at Crownover M.S., McMath M.S., Myers M.S., Navo M.S., Rodriguez M.S.
- Replace stage curtains at Crownover M.S., Harpool M.S., McMath M.S., Myers M.S., Navo M.S.
- At Calhoun M.S., replace stage sound system, stage A/V systems, and stage curtains



LONG-RANGE FACILITIES PLAN - CAPITAL IMPROVEMENT - SECONDARY

\$14,862,111

Ryan High School Expansion/Band Hall Reconfiguration

- Add new band hall and support areas comparable to Denton High
- Renovate existing band area to reclaim for academic classroom space
- Remove existing portable classroom facilities





Table Talk Q&A Process

Our Mission: Empowering lifelong learners to be engaged citizens who positively impact their local and global community.





SUPPORT FACILITIES



LONG-RANGE FACILITIES PLAN - SUPPORT FACILITIES

\$21,571,015

Calhoun M.S. Re-Purpose

- Renovate space for Technology Department use
- Renovate space for warehouse space use
- Renovate space for Fine Arts Department space
- Construct Network Operations Center



LONG-RANGE FACILITIES PLAN - SUPPORT FACILITIES

\$2,000,000

Maintenance Warehouse Facility

- Construct facility at Sisk Annex

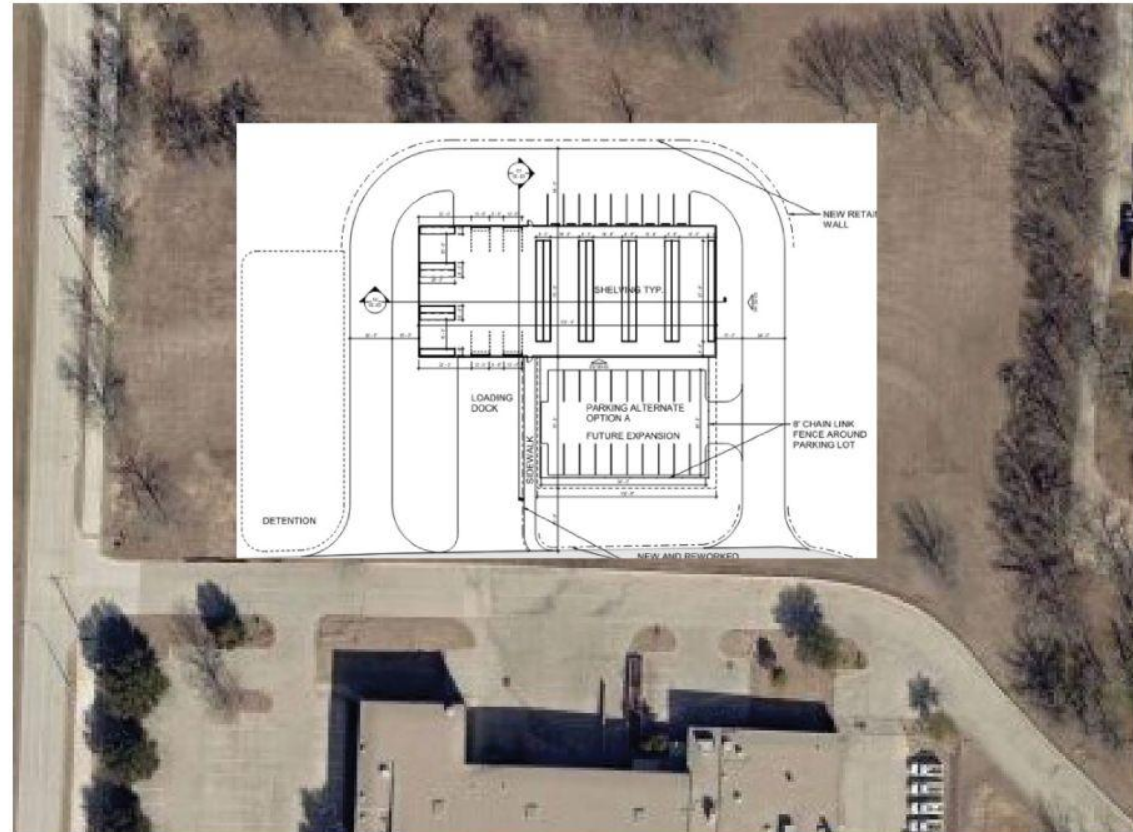



DISTRICT NEEDS



LONG-RANGE FACILITIES PLAN - DISTRICT NEEDS

\$46,028,174

HVAC Replacement

- Replace HVAC components and controls at:

Alexander ES	McNair ES Natatorium
LaGrone ATC	Nelson ES
Blanton ES	Navo MS
Calhoun MS	Paloma Creek ES
Central Services Building	Professional Development Center
C.H.Collins	Rayzor ES
Crwonover MS	Rivera ES
Davis ES	Ryan HS
Bronco Field Pressbox	Savannah ES
Evers ES	Stephens ES
Fred Moore HS	Strickland MS
Fred Moore DNS	West Transportation Center
Guyer HS	Harpool MS
Harpool MS	Natatorium
Hawk ES	
Hodge ES	
McMath ES	



LONG-RANGE FACILITIES PLAN - DISTRICT NEEDS

\$39,929,285

Roof Replacement

- Replace roof at:

Houston ES

Crownover ES

Evers ES

Hodge ES

McNair ES

Guyer HS

Stephens Administration

E.P.Rayzor ES

Savannah ES

Hawk ES

C.H.Collins

Press Box

Davis ES

Providence ES

Pecan Creek ES

W.S.Ryan ES



LONG-RANGE FACILITIES PLAN - DISTRICT NEEDS

\$100,120,452

Package 1

Technology Replacement, Improvements

- Lab/Library device refresh
- Printer equipment refresh
- Campus staff device refresh
- Classroom AV refresh
- Equipment Refresh
- Switch replacement
- Fiber infrastructure
- WiFi completion
- AV refresh for lecture halls, auditoriums, etc.



LONG-RANGE FACILITIES PLAN - DISTRICT NEEDS

\$19,033,546

Package 2

Technology Replacement, Improvements

- AV refresh for elementary, middle, and high school cafeterias and gymnasium.
- Added server capacity
- Wireless switches
- Software Digital signage refresh
- Optical infrastructure



LONG-RANGE FACILITIES PLAN - DISTRICT NEEDS

\$38,507,912

Safety and Security Upgrades

- Improve secure vestibule entries at multiple school campuses
- Replace select door hardware
- Replace access controls at select campuses
- Video management systems
- Campus MDF Refresh



LONG-RANGE FACILITIES PLAN - DISTRICT NEEDS

\$4,898,911

Food Service Equipment Replacement

- Replace equipment at select schools



LONG-RANGE FACILITIES PLAN - DISTRICT NEEDS

Transportation

- **Package 1 | \$13,063,504**
Replace 79 buses and upgrade transportation communications system
- **Package 2 | \$849,112**
Purchase 6 box trucks



LONG-RANGE FACILITIES PLAN - DISTRICT NEEDS

\$97,314,000

Land Purchase

- Provide funding to acquire land as considered necessary for potential new facilities



LONG-RANGE FACILITIES PLAN - DISTRICT NEEDS

Denton ISD
Land Requirements and Long-Term Planning
As of November 7, 2022

Map Location	Description	Acreage	Cost	School Site
1	Linden Hills - Eppright Rd.	16.000	\$ 1,760,000.00	Elementary 28
2	Spiritas Ranch / Centurion	13.000	\$ 1,250,000.00	Elementary 27
3	Naylor Rd and 380	32.835	\$ 9,780,000.00	Future School
4	Naylor Road - East Side	115.000	\$ 1,000,000.00	Swapping FM 720 Property - Acreage Difference
4	Naylor Road - West Side	80.000	\$ 17,424,000.00	Future Secondary Site
5	Ryan High School	6.000	\$ 1,100,000.00	Future Additions
	Future School Sites		\$ 65,000,000.00	Future High School / Middle School Site Cole/Hunter Future High School - Northern Area Future Elementary sites - West, North, and East Future Sites South Future Middle School Site
Total Land For Future School Sites			\$ 97,314,000.00	



LONG-RANGE FACILITIES PLAN - DISTRICT NEEDS



District Housing Overview

- The district has 67 actively building subdivisions
- Within Denton ISD there are 38 future subdivisions
- Groundwork is underway on approximately 4,034 lots within 23 subdivisions

Subdivisions

- ACTIVE
- FUTURE
- Groundwork Underway

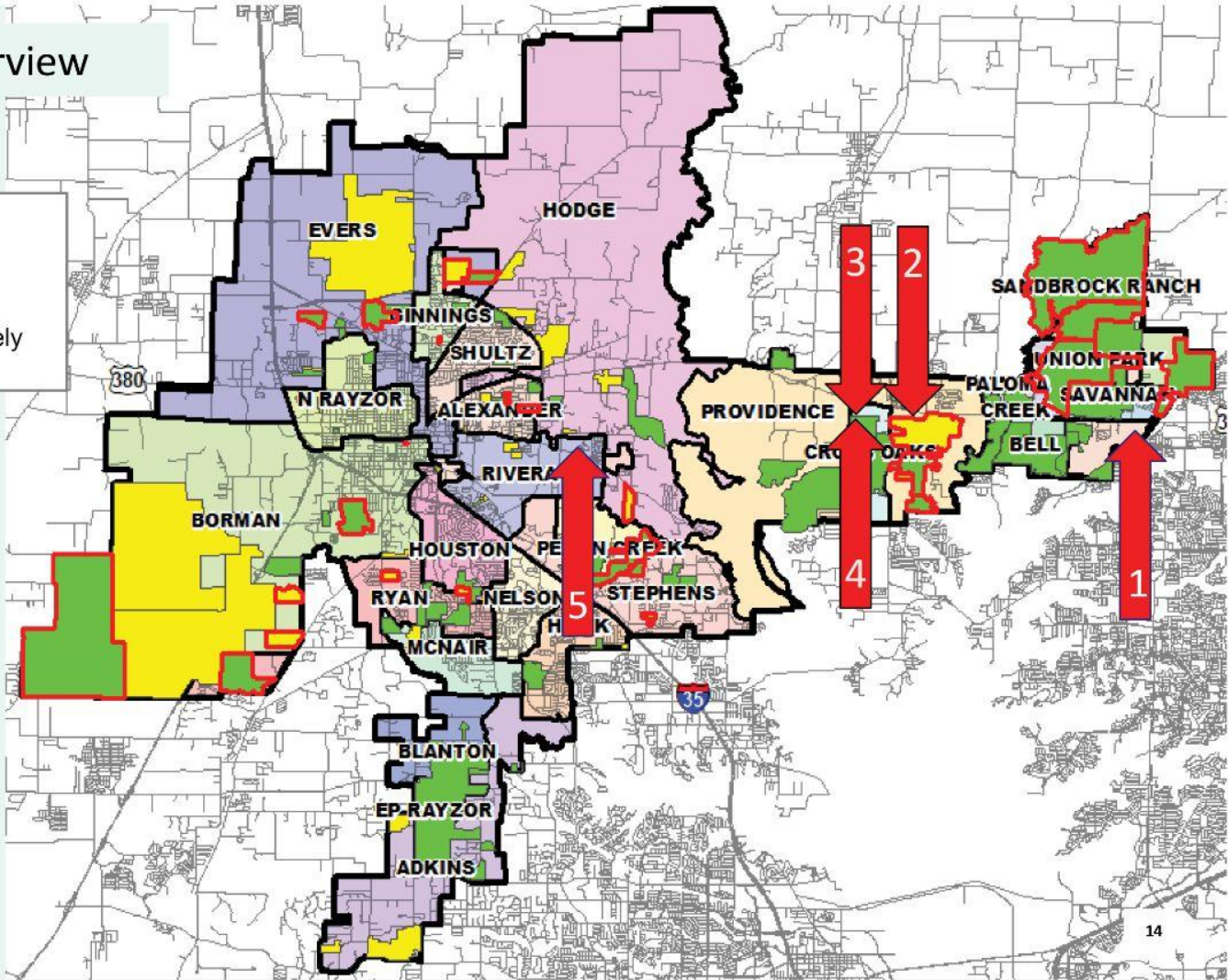



Table Talk Q&A Process

Our Mission: Empowering lifelong learners to be engaged citizens who positively impact their local and global community.





**THANK
YOU!**





Project Priority Worksheet

Our Mission: Empowering lifelong learners to be engaged citizens who positively impact their local and global community.





Telling the Story



Tuesday, November 29th

5:30pm Dinner
6pm-8pm Meeting

Curtis Ramsey
Professional
Development Center



Our Mission: Empowering lifelong learners to be engaged citizens who positively impact their local and global community.

